

User Manual of Banner Cutter

Installation:

Firstly, connect the cutter head and the expansion pole and then adjust the right length of the pole.



Secondly, insert the material you want to cut into the cutter head and fix it then hold the pole to cut with even distributed power.



How to Change the Blade?

Dismantle the Blade:

Firstly, loose the slide block and push it to the right side.



Then, insert the cutter head and take the blade out.



Instal the Blade:

Let one side of the slide block face down and it slide down soon, and then put the blade into the cutter head and lock it when the blade slides into the bottom side

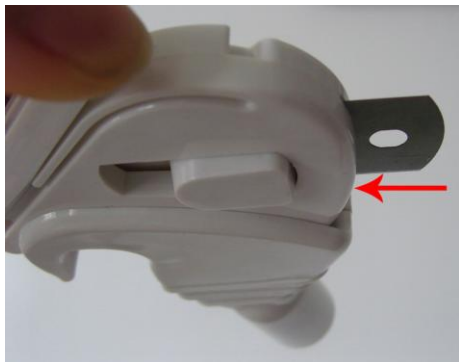

将推块推到左端，锁紧刀片

