



www.Sign-in-Global.us

CALIFORNIA GLOBAL-SIGNS INFORMATION TECHNOLOGY CO INC
Address: 4050 Greystone Dr ontario CA 91761
LIN 626 495 5716
Website: <https://www.sign-in-global.us>



Elite Tumbler Heat Press

USER MANUAL

Max Compatible Item: 30oz Skinny Tumbler

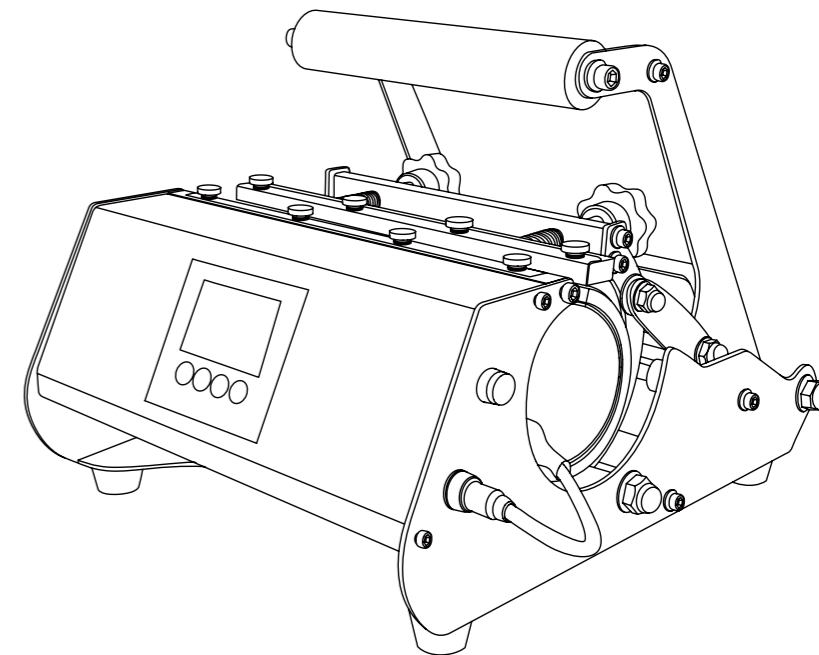

HTM-SIC300Z-270HN



STRUCTURE

Item No.	HTM-SIC30OZ-270HN	Time Range	0-999 seconds
Temp. Range	0-482 °F (0-250°C)	Voltage	220V / 110V
Max. Printable Size	30oz tumbler, 8cm in diameter, 24cm in height	Power	500W
Weight	8.3 kg	Packing	Foam packing, 1 set/ctn

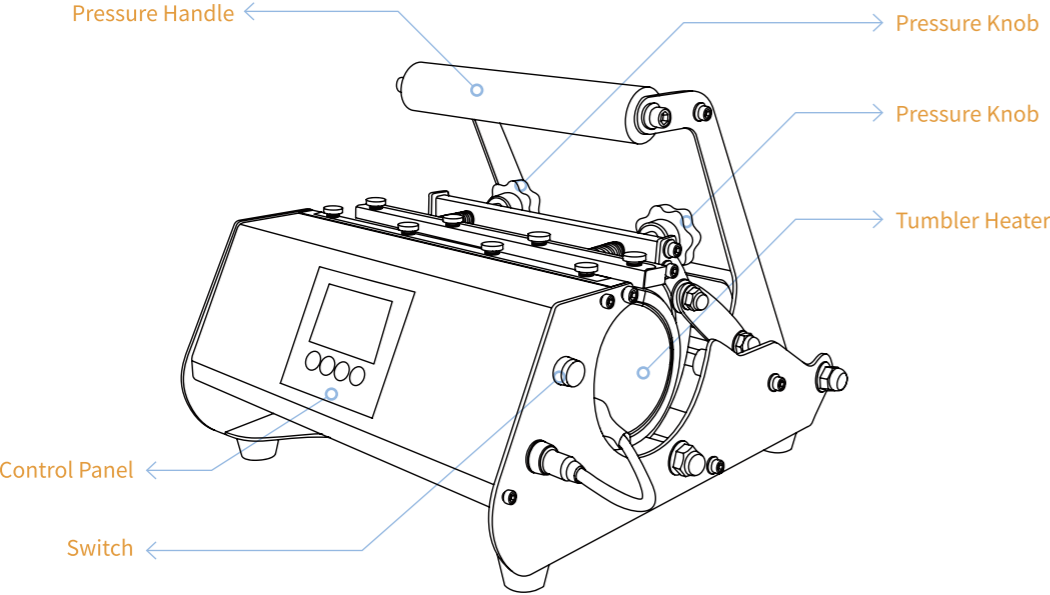

KNOW THE CONTROL PANEL

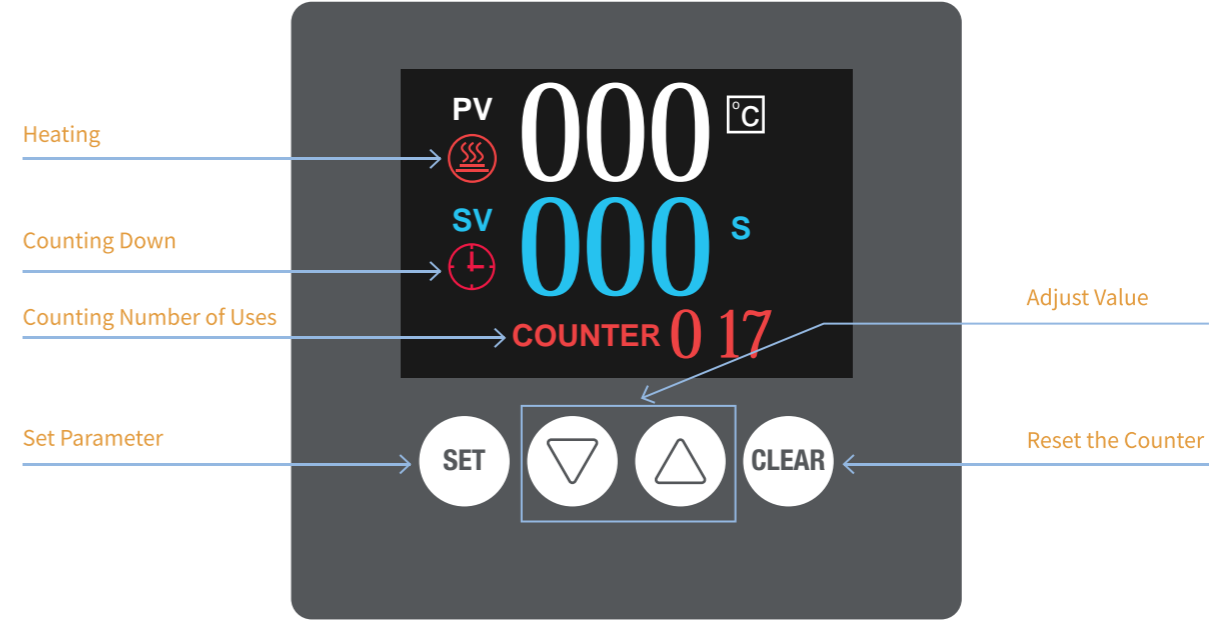

HOW TO USE THE CONTROL PANEL?

1. How to switch between °F and °C ?



1. Long press "SET" button for 5 seconds to enter temp. unit switching mode;



2. Press "↓" and "↑" buttons to switch between °F and °C ;



3. Long press "SET" button for 5 seconds again to save the setting.



As shown above, the current temperature unit is °C .



As shown above, the current temperature unit is °F .

2. How to clear the number of uses?



Long press "CLEAR" button for 8 seconds to reset the counter.



3. How to set printing time and temperature?



1. Turn on the machine, press "SET" button to enter temperature setting mode first;

Temp. Setting Interface



2. Press "↓" and "↑" buttons to adjusting the value;



3. Press "SET" button again to enter time setting mode;

Time Setting Interface



4. Press "↓" and "↑" buttons to adjusting the value;



5. Last, press "SET" button again to save the settings and exit setting mode.

Notes

- No matter which interface is shown, if the pressure handle is pressed down, the machine will start countdown automatically. You can lift it up to stop the countdown.
- No matter which interface is shown, if you press "CLEAR" button, the machine will start countdown automatically. You can press "CLEAR" button again to stop the countdown.

HOW TO USE?

1. Print on sublimation paper
2. Fix the image paper on a blank tumbler using thermal tape;
3. Put the tumbler into the heater, and adjust the printing pressure.
4. Take it out, plug in and turn on the machine;
5. Set printing time and temperature;
6. Wait until the machine heats up to the set temperature;
7. Put the tumbler into the heater, press down the handle, and the machine starts countdown;
8. After countdown, take out the tumbler and check the result.

Printing Parameters

No.	Item Name	Temp.	Time(S)	Remark
1	Stainless Steel Skinny Tumbler	180°C (356 °F)	60	1. Print on sublimation paper, mirror image; 2. Take off the lid before printing; 3. Use low pressure.
2	Ceramic/Glass Mug	180°C (356 °F)	280	1. Print on sublimation paper, mirror image; 2. Place the mug into the heater in proper position to avoid handle breaking; 3. Use medium pressure
3	Water Bottle (Aluminum/ Stainless Steel Material)	180°C (356 °F)	60	1. Print on sublimation paper, mirror image; 2. Take off the lid before printing; 3. Use low pressure.
4	Plastic Mug	180°C (356 °F)	280	1. Print on sublimation paper, mirror image; 2. Put the printing tool into the mug before printing to avoid deformation; 3. Use low pressure.

1. The parameters above are just for CraftExpress tumbler heat press machines.
2. The parameters above are for reference only. Please test to find the best parameters for your own product.

Safety Instructions

1. Don't touch the tumbler heater as the machine is heating or still hot.
2. This machine is not intended for use by children.



NOTES:

1. Do not heat the machine without a tumbler inside in case of burnout.
2. Do not touch the heater directly without any protection.
3. If the machine works for more than 1.5 hours, it is better to turn it off for a 20-minute break.

FAQS:

Colors are lighter	The temperature is too low, the pressure is uneven, or the time is too short.
Printed picture is vague	The printing time is long, which causes the ink spread.
Colors are less bright	The pressure is too high or the temperature is too high.
Printed picture is partially vague	The heat is uneven.
Colors are different	The pressure is uneven or the surface of the printed item is uneven.
The paper sticks on the printed item	The temperature is too high or the coating of the item is in poor quality.